

Series One EPG and EPM Heaters (Mfg. 1990-1992) Parts List and Diagram

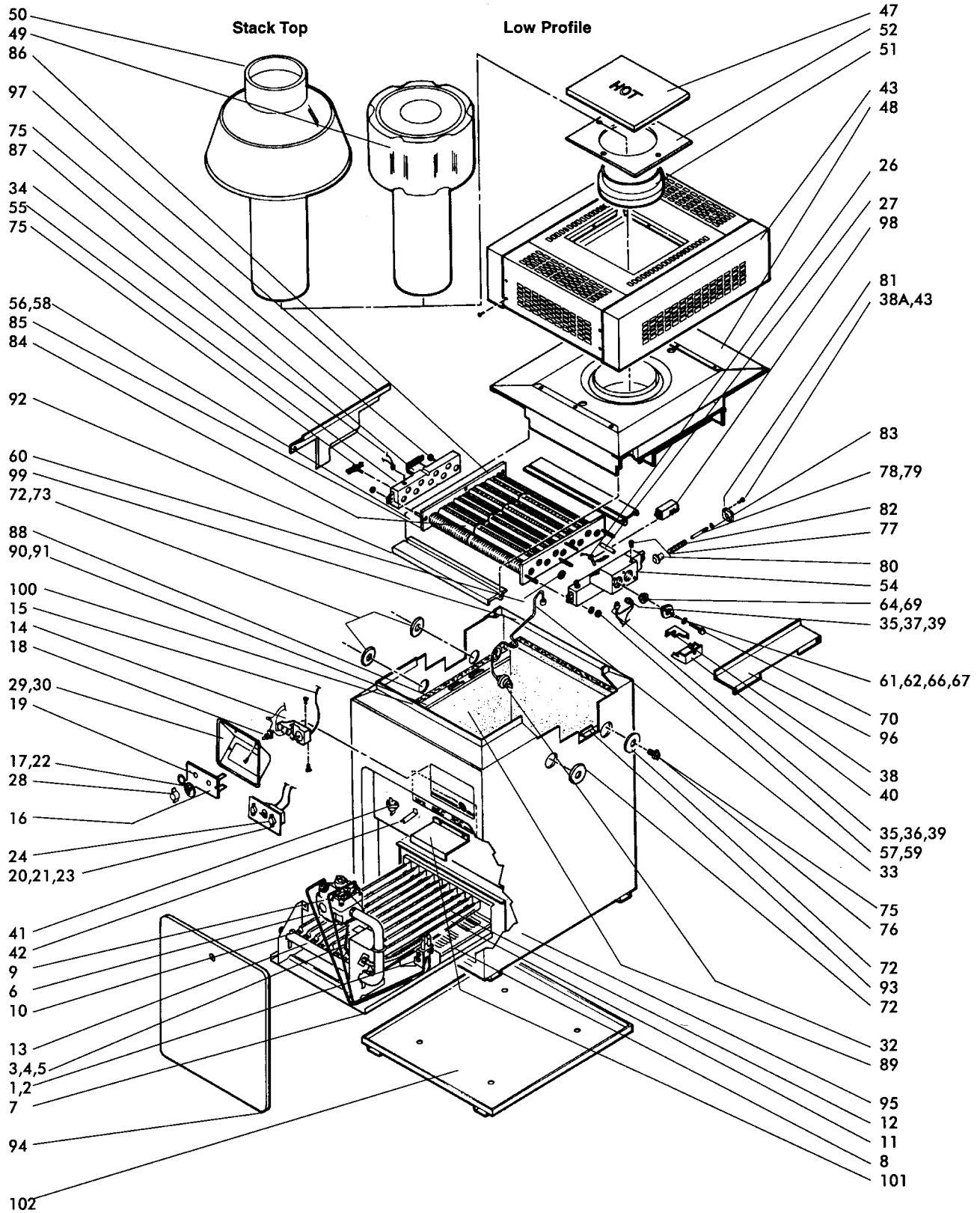

Series One EPG and EPM Heaters (Mfg. 1990-1992) Parts List and Diagram

Key No.	Description	Model No.	ORDER PART NO.	Key No.	Description	Model No.	ORDER PART NO.
PILOT GAS SYSTEM							
1	Pilot Burner/Gen. Assembly, NAT	All	R0027500	54	Inlet/Outlet Header, Bronze, 2"	All	R0016800
1	Pilot Burner/Gen. Assembly, LPG	All	R0027600	55	Return Header	All	R0058300
2	Pilot Generator	All	W0036901	55	Return Header, Bronze	All	R0054600
2	Pilot Generator (Note 3)	All	R0025500	56	Header Bolt Assembly	All	R0057000
3	Visoflame Tubing	All	N/A	57	Nut for Headers	All	F0003100
4	Lighter Tube Orifice, NAT	All	N/A	58	Bolt for Headers, 2 1/2"	All	F0046100
4	Lighter Tube Orifice, LPG	All	N/A	59	Washer for Headers	All	F0011100
5	Visoflame Lighter Tube	All	N/A	60	Header Gasket Assembly (Set of 18)	All	R0050800
6	Pilot Tubing	All	R0037000	61	Flange & Gasket Assy, 1 1/2" (Note 4 & 7)	All	R0031900
MAIN GAS SYSTEM							
7	Burner Tray Assembly, NAT (Note 1)	125-400	10578001-05	62	Flange, 1 1/2"	All	S0053300
7	Burner Tray Assembly, LPG (Note 1)	125-400	10578101-05	63	Flange Gasket, 1 1/2"	All	S0053100
8	Burner Tray, Shelf Only	125-400	R0317001-05	64	Flange Sleeve, 1 1/2"	All	S0028000
9	Gas Valve Assembly, NAT	All	R0027700	65	Flange Bolt	All	F0031700
9	Gas Valve Assembly, LPG	All	R0027800	66	Flange & Gasket Assembly, 2"	All	R0055000
9	Gas Valve, NAT	All	N/A	67	Flange, 2"	All	10573500
9	Gas Valve, LPG	All	N/A	68	Flange Gasket, 2"	All	S0078000
10	Gas Orifice, NAT (Note 1)	All	L0032200	69	Flange Sleeve, 2"	All	S0078200
10	Gas Orifice, LPG (Note 1)	All	L0032900	70	Flange Bolt	All	F0031700
11	Burner, Main w/Pilot Bracket	All	10457200	71	Flange Gasket 1 1/2 - 2"	All	S0078100
12	Burner, Main	All	L0052300	72	Grommet for Drain Plug	All	R0316300
13	Burner Manifold (Note 6)			73	Grommet, Slitted	All	S0071100
ELECTRICAL SYSTEM							
14	Temp Control Assembly - EPG (Note 6)	All	R0058200	74	Hole Plug	All	S0098700
15	Wire Harness	All	R0058000	75	Drain Plug (Note 5)	All	P0026800
16	Plate Assembly	All	10456300	76	Drain Plug Bushing	All	P0018500
17	"Temp-Lok" Stop Plate	All	10456700	77	Brass Plug, 3/4"	All	P0027000
18	On-Off Switch	All	R0094100	78	By-Pass Assembly	All	R0013100
19	Temperature Control Label	All	H0105300	79	By-Pass Valve Rod	All	S0079800
20	Temp Control Assy Elec/MV - EPM (Note 6)	All	R0015600	80	By-Pass Valve Disc	All	R0011500
21	Wire Harness	All	N/A	81	By-Pass Valve Cap	All	S0069100
22	"Temp-Lok" Stop Plate	All	10583100	82	By-Pass Valve Spring (Note 6)		
23	Temperature Control Label	All	H0201200	83	By-Pass Valve Gasket	All	R0011400
24	Knob, Single Bar	All	R0099900	84	Heat Exchanger Tube Assembly (Note 2)	125-400	R0018101-05
Key Items 25 -31 are for both R0058200 & R0015600							
25	Temperature Sensor	All	R0011800	85	Heat Exchanger Baffle (8 Required)	125-400	10697401-05
26	"O" Ring, Temperature Control Bulb	All	E0116400	86	Baffle Retainer	All	S0083900
27	Protector Sleeve, Bulb	All	10444900	87	Heat Exchanger Support Clip	All	N/A
28	Thermostat Knob, Black	All	R0010700	FIREBOX COMPONENTS			
29	Temperature Control Gasket	All	S0070000	88	Insulation, Fiberglass (Sold by Ft.)	All	T0002000
30	Bezel	All	S0069800	89	Side Tile, 22 3/8" x 16 1/2" (Note 8)	All	N/A
31	Stop Plate Screw	All	F0033300	90	Front Tile, 18 5/8" x 9 1/8" (Note 8)	125	N/A
32	Pressure Switch, 2 PSI	All	R0013200	90	Front Tile, 18 5/8" x 12 1/8" (Note 8)	175	N/A
32	Pressure Switch, 1 PSI	All	R0011300	90	Front Tile, 18 5/8" x 16 1/8" (Note 8)	250	N/A
32	Pressure Switch, 3 PSI	All	R0013000	90	Front Tile, 18 5/8" x 20 7/8" (Note 8)	325	N/A
33	Siphon Loop Assembly	All	R0057800	90	Front Tile, 18 5/8" x 25 7/8" (Note 8)	400	N/A
34	High-Limit Switch, Redundant 275°F	All	R0012800	91	Rear Tile, 22 15/16" x 9 1/8" (Note 8)	125	N/A
35	High-Limit Switch Assembly	All	R0023200	91	Rear Tile, 22 15/16" x 12 1/8" (Note 8)	175	N/A
36	High-Limit Switch, 135°F	All	R0022700	91	Rear Tile, 22 15/16" x 16 5/8" (Note 8)	250	N/A
37	High-Limit Switch, 150°F	All	R0023000	91	Rear Tile, 22 15/16" x 20 7/8" (Note 8)	325	N/A
38	High-Limit Switch Retainer Clip	All	10728500	91	Rear Tile, 22 15/16" x 25 7/8" (Note 8)	400	N/A
39	High-Limit Switch Retainer Boot	All	S0098900	92	Front and Rear Tile Cover	125-400	10314901-05
40	High-Limit Switch Cover	All	10418300	93	Side Tile Cover	All	10167300
41	Fusible Link Assembly	All	R0012200	JACKET COMPONENTS			
42	Fusible Link Bracket	All	10479900	94	Door with Latch	125-400	R0317401-05
VENT SYSTEM							
43	Top Assembly	All	R0081000-400	95	Jacket Assembly, Less Top Assembly	125-400	10447901-05
44	Grating, Front/Rear	All	10563001-05	96	Gap Closure In/Out Side	All	10448200
45	Grating, Sides	All	10518100	97	Gap Closure, Return Side	All	10448300
46	Top Panel	125-400	10517801-05	98	Insulation and Retainer	All	10462200
47	Top Filler	125-400	10535201-05	99	Rear Deflector	125-400	10563701-05
48	Flue Collector Assy	125-400	10564801-05	100	Lower Deflector	125-400	10563601-05
49	Outdoor Vent Cap	125-400	10561501-05	101	Rain Shield Valve	All	10523300
50	Indoor Drafthood	125-400	10561401-05	OPTIONAL COMPONENTS			
51	Flue Transition Ring	125-400	K0010301-05	102	Non-Combustible Floor Base	125-400	10521701-05
52	Adapter Plate	125-400	10535301-05		Pressure Relief Valve, 3/4" NPT, 75 PSI	All	R0040400
53	Clip	All	10211000		Flue Collar	125-400	10542201-05
WATER SYSTEM							
54	Inlet/Outlet Header, 1 1/2"	All	R0058400		Touch Up Spray Paint	All	X0016000
54	Inlet/Outlet Header, Bronze, 1 1/2"	All	R0054700	Notes:			
54	Inlet/Outlet Header 2"	All	R0056400	1. For altitudes higher than 2000 feet above sea level consult factory for orifice size. 2. Order assembly R0057000 for complete set of bolts. 3. Direct replacement for heaters with G/C Pilot Burner/Generator assemblies. 4. Available in bronze as assembly R0015000. 5. Current available replacement. 6. See Appendix 7. Two included in assembly. 8. Use kit R0325301-05. All sides included.			