

Series One EPC and EPS Heaters (Mfg. 1990-1992) Parts List and Diagram

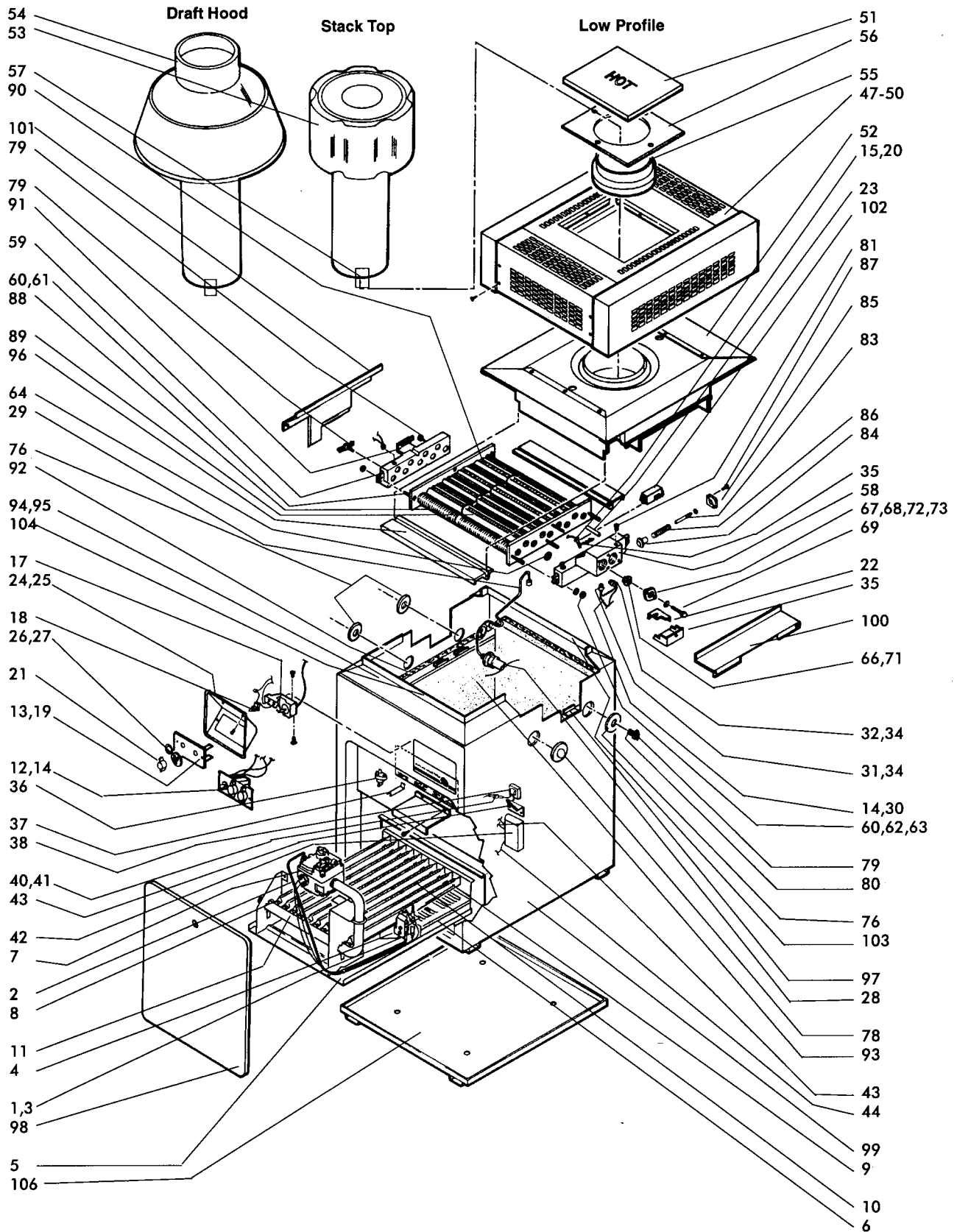

Series One EPC and EPS Heaters (Mfg. 1990-1992) Parts List and Diagram

Key No.	Description	Model No.	ORDER PART NO.	Key No.	Description	Model No.	ORDER PART NO.
PILOT GAS SYSTEM				WATER SYSTEM			
1	Pilot Burner/Electrode, NAT	All	R0061600	58	Inlet/Outlet Header, 1 1/2"	All	R0058400
1	Pilot Burner, LPG	All	W0038300	58	Inlet/Outlet Header, Bronze, 1 1/2"	All	R0054700
2	Pilot Tubing	All	R0037000	58	Inlet/Outlet Header, 2"	All	R0056400
3	Flame Sensor, LPG	All	W0037500	58	Inlet/Outlet Header, Bronze, 2"	All	R0016800
4	Ceramic Insulator Assembly	All	R0011600	59	Return Header	All	R0058300
MAIN GAS SYSTEM				59	Return Header, Bronze	All	R0054600
5	Burner Tray Assembly, NAT (Note 1)	125-400	10458301-05	60	Header Bolt Assembly	All	R0057000
5	Burner Tray Assembly, LPG (Note 1)	125-400	10610801-05	61	Bolt for Headers, 2 1/2"	All	F0046100
6	Burner Tray, Shelf Only	125-400	R0317001-05	62	Washer for Headers	All	F0011100
7	Gas Valve, NAT	125-175	R0039200	63	Nut for Headers	All	F0003100
7	Gas Valve, NAT	250-400	R0038400	64	Header Gasket Assembly (Set of 18)	All	R0050800
7	Gas Valve, LPG	All	R0028200	65	Flange & Gasket Assy, 1 1/2" (Note 3 & 7)	All	R0031900
8	Gas Orifice, NAT (Note 1)	All	L0032200	66	Flange, 1 1/2"	All	S0053300
8	Gas Orifice, LPG (Note 1)	All	L0032900	67	Flange Gasket, 1 1/2"	All	S0053100
9	Burner, Main w/Pilot Bracket	All	10457500	68	Flange Sleeve, 1 1/2"	All	S0028000
10	Burner, Main	All	L0052300	69	Flange Bolt	All	F0031700
11	Burner Manifold (Note 6)			70	Flange & Gasket Assembly, 2" (Note 7)	All	R0055000
ELECTRICAL SYSTEM				71	Flange, 2"	All	10573500
12	Temperature Control Assy-EPS, EPC II (Note 6)	All	R0011700	72	Flange Gasket, 2"	All	S0078000
13	Temperature Control Plate	All	10594600	73	Flange Sleeve, 2"	All	S0078200
14	Wire Harness	All	10457800	74	Flange Bolt	All	F0031700
15	Temperature Sensor	All	R0011800	75	Flange Gasket 1 1/2 - 2"	All	S0078100
16	Knob, Single Bar	All	R0099900	76	Grommet for Drain Plug	All	R0316300
17	Temperature Control Assembly - EPC (Note 6)	All	R0318800	77	Grommet, Slitted	All	S0071100
18	On-Off Switch	All	R0094100	78	Hole Plug	All	S0098700
19	Temperature Control Plate	All	10456300	79	Drain Plug (Note 5)	All	P0026800
20	"O" Ring, Temperature Control Bulb	All	E0036300	80	Drain Plug Bushing	All	P0018500
20A	Wire Harness	All	R0058000	81	Brass Plug, 3/4"	All	P0027000
Items 21 - 27 are for both R117 & R3188:				82	By-Pass Assembly	All	R0013100
21	Thermostat Knob, Black	All	R0010700	83	By-Pass Valve Rod	All	S0079800
22	"O" Ring, Temperature Control Bulb	All	E0116400	84	By-Pass Valve Disc	All	R0011500
23	Protector Sleeve, Bulb	All	10444900	85	By-Pass Valve Cap	All	50069100
24	Bezel	All	S0069800	86	By-Pass Valve Spring (Note 6)		
25	Temperature Control Gasket	All	S0070000	87	By-Pass Valve Gasket	All	R0011400
26	"Temp-Lok" Stop Plate	All	10583100	88	Heat Exchanger Tube Assembly (Note 2)	125-400	R0018101-05
27	Stop Plate Screw	All	F0033300	89	Heat Exchanger Baffle (8 Required)	125-400	10697401-05
28	Pressure Switch, 1 PSI	All	R0011300	90	Baffle Retainer	All	S0083900
28	Pressure Switch, 2 PSI	All	R0013200	91	Heat Exchanger Support Clip	All	N/A
28	Pressure Switch, 1-10 PSI	All	R0015500	FIREBOX COMPONENTS			
29	Siphon Loop Assembly	All	R0057800	92	Insulation, Fiberglass (Sold by Ft.)	All	T0002000
30	High-Limit Switch Assembly	All	R0023200	93	Side Tile, 22 3/8" x 16 1/2" (Note 8)	All	N/A
31	High-Limit Switch, 135°F	All	R0022700	94	Front Tile, 18 5/8" x 9 1/8" (Note 8)	125	N/A
32	High-Limit Switch, 150°F	All	R0023000	94	Front Tile, 18 5/8" x 12 1/8" (Note 8)	175	N/A
33	High-Limit Switch Retainer Clip	All	10728500	94	Front Tile, 18 5/8" x 16 1/8" (Note 8)	250	N/A
34	High-Limit Switch Retainer Boot	All	S0098900	94	Front Tile, 18 5/8" x 20 7/8" (Note 8)	325	N/A
35	High-Limit Switch Cover	All	10418300	94	Front Tile, 18 5/8" x 25 7/8" (Note 8)	400	N/A
36	Fusible Link Assembly	All	R0012200	95	Rear Tile, 22 15/16" x 9 1/8" (Note 8)	125	N/A
37	Fusible Link Bracket	All	10479900	95	Rear Tile, 22 15/16" x 12 1/8" (Note 8)	175	N/A
38	Transformer (115V-230V/24V)	All	R0061100	95	Rear Tile, 22 15/16" x 16 5/8" (Note 8)	250	N/A
39	Wire Harness Complete EPS, EPC II (not shown)	All	R0058100	95	Rear Tile, 22 15/16" x 20 7/8" (Note 8)	325	N/A
40	Fuse Packet, 1.25 Amp	All	R0012300	95	Rear Tile, 22 15/16" x 25 7/8" (Note 8)	400	N/A
41	In-Line Fuse Assembly	All	10480000	96	Front and Rear Tile Cover	125-400	10314901-05
42	Ignition Control, NAT	All	R0011900	97	Side Tile Cover	All	10167300
42	Ignition Control, LPG	All	E0112300	JACKET COMPONENTS			
43	Ignition Control Wire Harness	All	R0059800	98	Door with Latch	125-400	R0314701-05
43	Ignition Control Rain Guard	All	N/A	99	Jacket Assembly, Less Top Assembly	125-400	10447901-05
44	High Voltage Lead Assembly, NAT	All	10449513	100	Gap Closure In/ Out Side	All	10448200
44	High Voltage Lead Assembly, NAT (Note 4)	All	R0012100	101	Gap Closure, Return Side	All	10448300
44	High Voltage Lead Assembly, LPG (Red Wire)	All	R0012100	102	Insulation and Retainer	All	10462200
45	Sensor Wire, LPG (not shown)	All	E0112900	103	Rear Deflector	125-400	10563701-05
46	Ignition Wire, LPG (Orange Wire) (not shown)	All	E0112800	104	Lower Deflector	125-400	10563601-05
VENT SYSTEM				105	Rain Shield Valve	All	10523300
47	Grate Top Assembly	All	R0081000-400	OPTIONAL COMPONENTS			
48	Grating, Front/Rear	All	10563021-05	106	Non-Combustible Floor Base	125-400	10521701-05
49	Grating, Sides	All	10518100		Remote Control Wire Harness - EPC II / EPS	All	N/A
50	Top Panel	125-400	10517801-05		Remote Control	All	N/A
51	Top Filler	125-400	10535201-05		Pressure Relief Valve 3/4" NPT, 75 PSI	All	R0040400
52	Flue Collector Assembly	125-400	10564801-05		Touch Up Spray Paint	All	X0016000
53	Outdoor Vent Cap	125-400	10561501-05				
54	Indoor Drafthood	125-400	10561401-05				
55	Flue Transition Ring	125-400	K0010301-05				
56	Adapter Plate	125-400	10535301-05				
57	Clip	All	10211000				

Notes: 1. For altitudes higher than 2000 ft. above sea level consult factory for orifice size.
 2. Order assembly R0057000 for complete set of bolts. 3. Available in bronze as assembly R0015000. 4. For heaters with H/W Ignition Control S86F or 286E only. 5. Current available substitute. 6. See Appendix 7. Two included in assembly 8. Use kit R0325301-05 to replace. All four sides included.